

This revision outlines changes that have occurred since the printing of your manual. Use this information to supplement your manual.

**REVISION CHANGE:**

On page 11-7, Section 11.6, "Mid-Power (20-40/25-50/35W) Radio Exploded View," the following items have been added to Table 11-6, "Mid-Power (20-40/25-50/35W Radio Parts List."

Item No.	Motorola Part No.	Description
20	3080239N03 2805407Z02 or 9859070E01	CABLE, PA Ribbon (UHF R3&3.5) CONNECTOR, Filtered (UHF R3&3.5) CONNECTOR, Filtered (UHF R3&3.5)
30	2680010M04	HEATSINK, Mid-Power Amplifier (PA) Masked (UHF R3&3.5)
31	3280088M02	GASKET, Accessory Connector Conductive (UHF R3&3.5)



**FMR-2047-1**



**This Page Intentionally Left Blank**

### 11.6 Mid-Power (20-40/25-50/35W) Radio Exploded View

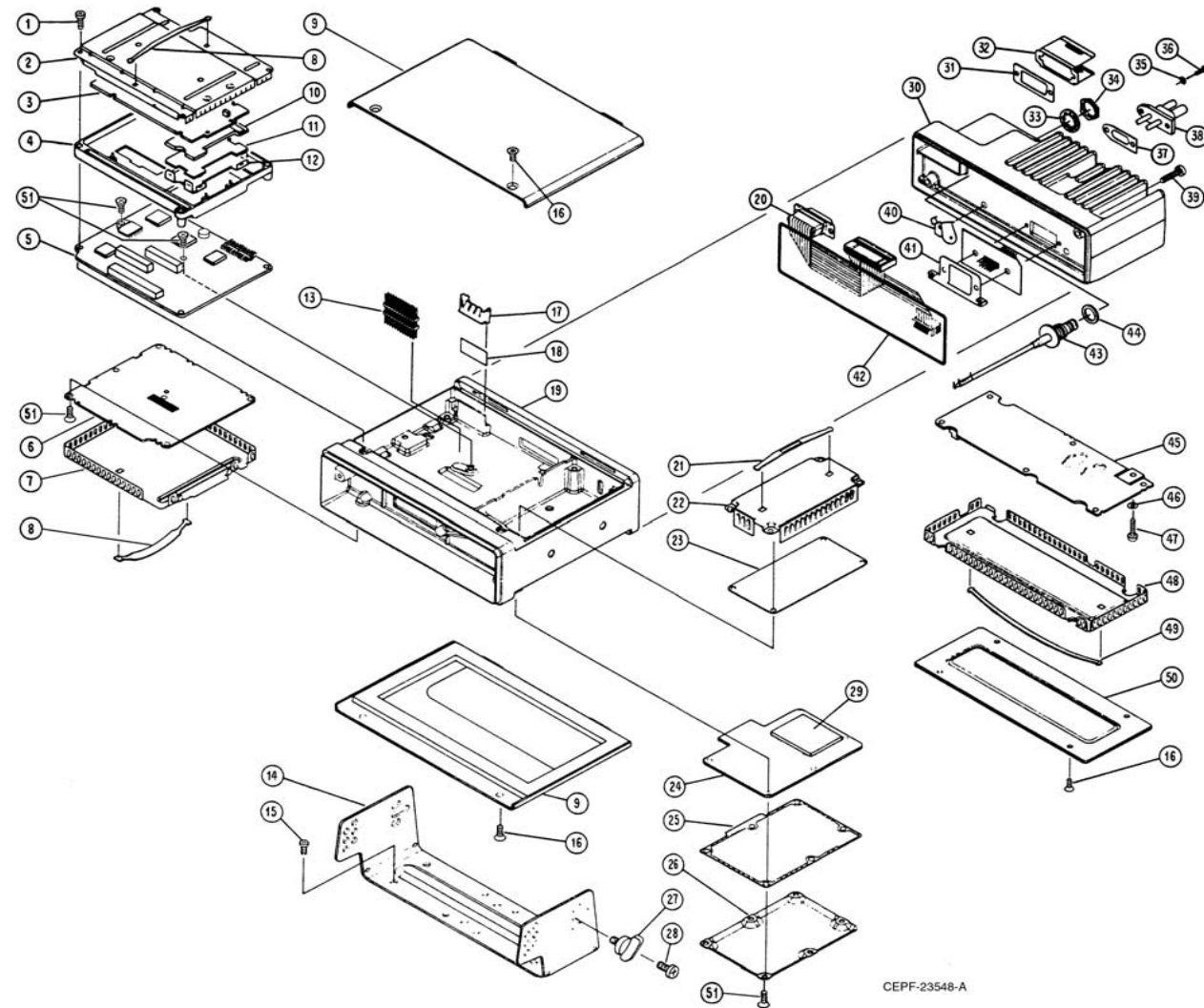

Figure 11-6. Mid-Power (20-40/25-50/35W) Radio Exploded View

Table 11-6. Mid-Power (20-40/25-50/35W) Radio Parts List

Item No.	Motorola Part No.	Description
1	0312016A27	SCREW, Tapping 3.5 x 0.6 x 22 (Board Mounting)
2	2605704V02	SHIELD, Top
3	HLN6458_	BOARD KIT, Controller
4	2705703V02	CASTING, Controller
5	HLN5558_	Kit, Command Board
6	HRN6014_ or HRN6020_ or HRN6019_	KIT, RF Board (VHF) KIT, RF Board (UHF) KIT, RF Board (800 MHz)
7	1580099L01	SHIELD, RF Board
8	5584300B01	HANDLE (Qty 2)
9	1580264N04	COVER (Includes gasket)
10	2605131X01	SHIELD, Encryption Board (Optional)
11	-----	BOARD, Encryption (Optional)
12	4205566W01	CLIP, Encryption Board (Optional)
13	2880260M01	HEADER, Floating
14	0780086N01	TRUNNION, Mounting
15	0312002B14	SCREW, Self-Drilling 10-16 x 10 (Qty 4)
16	0380102P01	SCREW, Tapping 3.5 x 0.6 x 10 (Qty 8)
17	4280007M01	CLIP, Regulator
18	1480001M01	INSULATOR, Regulator
19	2780082N01	CHASSIS, Consolidated
20	3080239N02 3080239N03 2805407Z02 or 9859070E01	CABLE, PA Ribbon CABLE, PA Ribbon (UHF R3&3.5) CONNECTOR, Filtered (UHF R3&3.5) CONNECTOR, Filtered (UHF R3&3.5)
21	5584300B01	HANDLE (Qty 2)
22	1580098L01	COVER, Front-End Receiver
23	HRD6001_ or HRD6002_ or HRE6001_ or HRE6002_ or HRE6003_ or HRE6004_ or HRF6004_	KIT, Front-End Receiver Board (VHF Range 1, 136-162MHz) KIT, Front-End Receiver Board (VHF Range 2, 146-174MHz) KIT, Front-End Receiver Board (UHF Range 1, 403-433MHz) KIT, Front-End Receiver Board (UHF Range 2, 438-470MHz) KIT, Front-End Receiver Board (UHF Range 3, 450-482MHz) KIT, Front-End Receiver Board (UHF Range 4, 482-512MHz) KIT, Front-End Receiver Board (800 MHz)
24	HLD6000_ or HLE6046_ or HLF6080_	KIT, VCO Board (VHF) KIT, VCO Board (UHF) KIT, VCO Board (800 MHz)
25	3280247N01	GASKET, VCO
26	1580097L01	COVER, VCO Board
27	0384244C06	SCREW, Wing 5 x 0.8 x 10 (Qty 4)
28	0380114M02	SCREW, Machine 5 x 0.8 x 10 (Qty 8)

Table 11-6. Mid-Power (20-40/25-50/35W) Radio Parts List

Item No.	Motorola Part No.	Description
29	HLD6061_ or HLD6062_ or HLE6101_ or HLE6102_ or HLE6103_ or HLE6104_ or HLF6079_ or 1580223N02	KIT, VCO Hybrid Board (VHF Range 1, 136-162MHz) KIT, VCO Hybrid Board (VHF Range 2, 146-174MHz) KIT, VCO Hybrid Board (UHF Range 1, 403-433MHz) KIT, VCO Hybrid Board (UHF Range 2, 438-470MHz) KIT, VCO Hybrid Board (UHF Range 3, 450-482MHz) KIT, VCO Hybrid Board (UHF Range 4, 482-512MHz) Kit, VCO Hybrid Board (800 MHz) COVER, VCO Hybrid (not included in item 29)
30	2680010M02 2680010M04	HEATSINK, Mid-Power Amplifier (PA) HEATSINK, Mid-Power Amplifier (PA) Masked (UHF R3&3.5)
31	3280088M01 3280088M02	GASKET, Accessory Connector GASKET, Accessory Connector Conductive (UHF R3&3.5)
32	4280016M03	CLIP, Accessory Connector
33	0400132718	LOCKWASHER, Internal Tooth
34	0280142M01	NUT, Hex, 7/16"
35	0400131974	WASHER, Flat
36	0380043L01	SCREW, Metric 3.0 x 10 (Qty. 4)
37	3280015M01	GASKET, Power Connector
38	0980272N02	CONNECTOR, Power
39	0380077M06	SCREW, Hex Socket (Qty 2)
40	4280264M02	CLIP, PA Coax
41	4280192N01	CLIP, Coax
42	3280053P01	GASKET, Heatsink
43	3080261M04	CABLE, Mini (includes items 33 and 34)
44	3280089M02	GASKET, Antenna
45	HLD6066_ or HLD6032_ or HLD6022_ or HLE6049_ or HLE6062_ or HLE6043_ or HLE6044_ or HLF6077_	KIT, Mid-Power PA Board (25-50W; VHF Range 1 136-162MHz) KIT, Mid-Power PA Board (25-50W; VHF Range 2, 146-174MHz) KIT, Mid-Power PA Board (25-50W; VHF Range 2, 146-174MHz) KIT, Mid-Power PA Board (20-40W; UHF Range 1, 403-433MHz) KIT, Mid-Power PA Board (20-40W; UHF Range 1, 403-433MHz) KIT, Mid-Power PA Board (20-40W; UHF Range 3, 450-482MHz) KIT, Mid-Power PA Board (20-40W; UHF Range 4, 482-512MHz) KIT, Mid-Power PA Board (35W; 800 MHz)
46	0480217E01	WASHER, Compression
47	0310911A11	SCREW, Machine 3.5 x 0.5 x 8
48	2680186M01	SHIELD, PA
49	5584300B04	HANDLE
50	1580048N01	Cover, PA Mid-Power
51	0310943J15	SCREW, Tapping 3.5 x 0.6 x 8
<b>NON-REFERENCED ITEMS</b>		
	3080091M01	CABLE, Speaker
	7505295B01	PAD, Crystal
	7580094M05	Pad, VF Display Shock (Qty 3)

Note: \_ = The latest version kit. When ordering, refer to your specific kit for this suffix letter.

### 11.7 High-Power (50-110W) Radio Exploded View

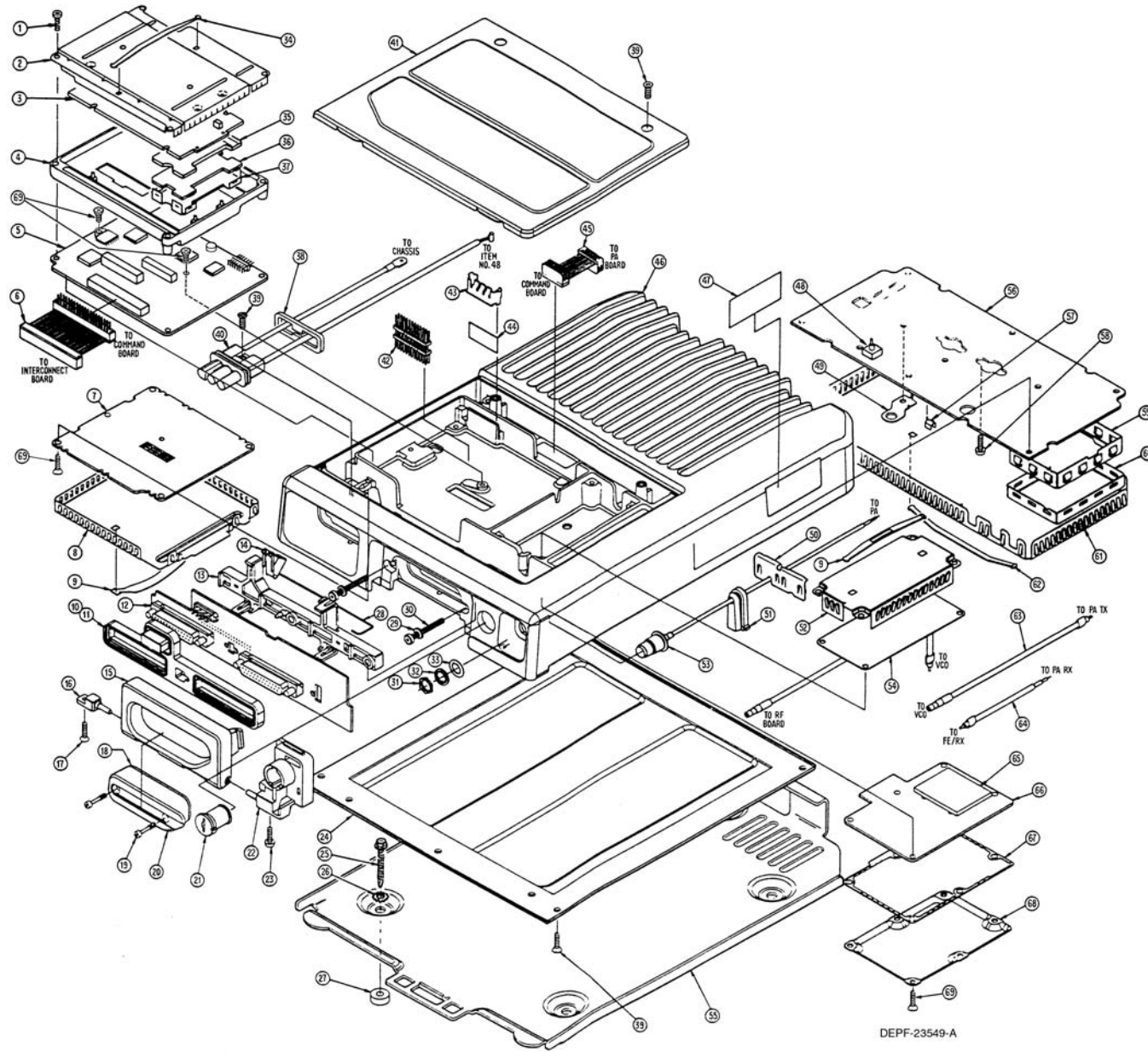

Figure 11-7. High-Power (50-110W) Radio Exploded View

Table 11-7. High-Power (50-110W) Radio Parts List

Item No.	Motorola Part No.	Description
1	0312016A27	SCREW, Tapping 3.5 x 0.6 x 22 (Board Mounting)
2	2605704V02	SHIELD, Top
3	HLN6458_	KIT, Controller Board
4	2705703V02	CASTING, Controller
5	HLN5558_	KIT, Command Board
6	3080211R01	CABLE, Command Bd to Interconnect Bd Ribbon

Table 11-7. High-Power (50-110W) Radio Parts List

Item No.	Motorola Part No.	Description
7	HRN6014_ or HRN6020_ or HRN6019_	KIT, RF Board (VHF) KIT, RF Board (UHF) KIT, RF Board (800 MHz)
8	1580099L01	SHIELD, RF Board
9	5584300B01	HANDLE (Qty 2)
10	3280206R01	GASKET, Connector
11	3280206R02	GASKET, SecureNet Connector
12	HLN5558_	KIT, Interconnect Board
13	4380110R01	SPACER, Interconnect Board
14	4280232R01	CLIP, Interconnect Board
15	5580102R01	HANDLE
16	4780176P01	PIN, Pivot
17	0310943R55	SCREW, Tapping
18	3280118R01	COVER Gasket
19	0380214R01	SCREW, Captive
20	3880122R01	CONNECTOR
21	5580370A01	LOCK
22	1580218R01	HOUSING, Lock (Non-replacable item)
23	0380043L01	SCREW, Tapping (Non-replacable item)
24	1580216R01	COVER, Bottom
25	0312002A28	SCREW, Self-Drilling
26	0400007688	LOCKWASHER
27	4382292M01	BUSHING, Spacer
28	4280210R01	RETAINER, Wire
29	0405171J03	WASHER, Fiber
30	0310908A97	SCREW, Machine
31	0280242M01	NUT, Hex; 7/16"
32	0400132718	LOCKWASHER, Internal-Tooth 7/16"
33	0480285R01	WASHER, Special
34	5584300B01	HANDLE
35	2605131X01	SHIELD, Encryption Board (Optional)
36	-----	BOARD, Encryption (Optional)
37	4205566W01	CLIP, Encryption Board (Optional)
38	3205457V01	GASKET, Power Connector
39	0380102P01	SCREW, Tapping
40	3080114R02	CONNECTOR, Power
41	1580217R01	COVER, Top
42	2880260M03	HEADER, Floating
43	4280007M02	CLIP, Regulator
44	1480001M01	INSULATOR, Regulator
45	3080212R01	CABLE, Command Bd to PA Bd Ribbon
46	2780133P02	CHASSIS
47	3380080E01	NAMEPLATE, FCC
48	0780255R01	BRACKET, Feed-Through
49	2680201R01	HEATSINK Diode-Bracket
50	4280261R01	CLIP, Coaxial Antenna
51	3280120R01	GASKET, Mini-Internal Connector
52	1580098L01	SHIELD, Front-End Receiver
53	3080261M03	CABLE, Mini

Table 11-7. High-Power (50-110W) Radio Parts List

Item No.	Motorola Part No.	Description
54	HRD6001_ or HRD6002_ or HRE6001_ or HRE6002_ or HRE6003_ or HRE6004_ or HRF6004_	KIT, Front-End Receiver Board (VHF Range 1, 136-162MHz) KIT, Front-End Receiver Board (VHF Range 2, 146-174MHz) KIT, Front-End Receiver Board (UHF Range 1, 403-433MHz) KIT, Front-End Receiver Board (UHF Range 2, 438-470MHz) KIT, Front-End Receiver Board (UHF Range 3, 450-482MHz) KIT, Front-End Receiver Board (UHF Range 4, 482-512MHz) KIT, Front-End Receiver Board (800 MHz)
55	1580132P01	TRAY, Mounting
56	HLD6064_ or HLD6063_ or HLE6051_ or HLE6039_ or HLE6040_	KIT, High-Power PA Board (50-110W; VHF Range 1, 136-162MHz) KIT, High-Power PA Board (50-110W; VHF Range 2, 146-174MHz) KIT, High-Power PA Board (50-110W; UHF Range 1, 403-433MHz) KIT, High-Power PA Board (50-110W; UHF Range 3, 450-482MHz) KIT, High-Power PA Board (50-110W; UHF Range 4, 482-512MHz)
57	4280202R01	CLIP, Coaxial
58	0310911A11	SCREW, Machine
59	2680139P01	SHIELD, Harmonic Filter
60	1580208R01	COVER, Harmonic Shield
61	2680138P02	SHIELD, Power Amplifier (PA)
62	5584300B04	HANDLE, PA Shield
63	3080152M15	CABLE, Coaxial Transmitter
64	3080037R12	CABLE, Coaxial Receiver
65	HLD6061_ or HLD6062_ or HLE6101_ or HLE6102_ or HLE6103_ or HLE6104_ or HLF6079_ or 1580223N02	KIT, VCO Hybrid Board (VHF Range 1, 136-162MHz) KIT, VCO Hybrid Board (VHF Range 2, 146-174MHz) KIT, VCO Hybrid Board (UHF Range 1, 403-433MHz) KIT, VCO Hybrid Board (UHF Range 2, 438-470MHz) KIT, VCO Hybrid Board (UHF Range 3, 450-482MHz) KIT, VCO Hybrid Board (UHF Range 4, 482-512MHz) KIT, VCO Hybrid Board (800 MHz) COVER, VCO Hybrid (not included in item 29)
66	HLD6000_ or HLE6046_ or HLF6080_	Kit, VCO Board (VHF) Kit, VCO Board (UHF) Kit, VCO Board (800 MHz)
67	3280247N01	GASKET, VCO
68	1580097L01	COVER, VCO Board
69	0310943J15	SCREW, Tapping 3.5 x 0.6 x 8
<b>NON-REFERENCED ITEMS</b>		
	3080091M01	CABLE, Speaker
	7505295B01	PAD, Crystal
	7580094M05	PAD, VF Display Shock (Qty 3)

Note: \_ = The latest version kit. When ordering, refer to your specific kit for this suffix letter.